

PRODUCT PORTFOLIO

GEN NEXT SERIES



EVOLVE with CHANGE

The new identity of **ESBEE** is based on the strong fundamentals of **Sustainability, Growth and Commitment towards the environment and the society...**



Our new personality,

Gives the impression of an 'Arrow' indicating speed and direction. **ESBEE** written in white reflects Purity, Ethics and Perfection. The Light Green background represents safety, a prominent feature in all our products. Dark green colour means ability to surge ahead and our logo symbolizes the same. The subtle line in yellow represents the youthfulness & intellectual energy of our company.



INDEX

CONTENTS	PAGES
16 mm GEN NEXT LED INDICATORS	>>02<<
22.5 mm GEN NEXT LED INDICATORS	>>02<<
eNTEGRAL ACTUATOR	>>03<<
PUSH BUTTON STATIONS	>>04<< >>05<<
GEN NEXT PUSH BUTTON ACTUATOR	>>06<<
GEN NEXT PUSH BUTTON ACTUATOR & CONTACT BLOCKS	>>07<<
GEN NEXT LED ACTUATORS	>>08<<
TOWER LIGHTS	>>09<< >>10<< >>11<<
TECHNICAL SPECIFICATIONS	>>12<< >>13<<

16 mm GEN NEXT LED INDICATORS

- > Sleek & Integral Design
- > Special fire retardant plastic used
- > Easy mounting & wiring
- > Uniform & Bright Illumination
- > Operating life more than 0.1 million Burning hrs
- > Wide Voltage range
- > Available in 6 different colours
- > Withstand 2 KV surge test & passes 1.5 KV HV test for 60 seconds
- > Inbuilt IP20 protection for terminals & IP65



16mm LED Indicator

Cat. No. : SIL□□□□□

Colour (4th Digit) : **R** **G** **Y** **W** **B** **A**

Voltage (5th, 6th, 7th & 8th Digit):

012 C - 12 V AC/DC
024 C - 24 V AC/DC
048 C - 48 V AC/DC
064 C - 64 V AC/DC
110 A - 110 V AC/DC
240 A - 240 V AC

22.5 mm GEN NEXT LED INDICATORS

- > Gen Next LED Indicator with SMD LED technology
- > New sleek and compact design
- > Lug wiring possible
- > Uniform & bright illumination
- > Wide voltage range
- > Operating life more than 0.1 million Burning hrs
- > Can be assembled in push button stations
- > Integrated IP 20 protection for terminals & IP 65 protection
- > Passes surge test of 2 KV & HV test of 1.5KV
- > **CE & UL** approved



Gen Next LED Indicator

Cat. No. : EIL□□□□□

Colour (4th Digit) : **R** **G** **Y** **W** **B** **A**

Voltage (5th, 6th, 7th & 8th Digit):

012 C - 12 V AC/DC
024 C - 24 V AC/DC
048 C - 48 V AC/DC
064 C - 64 V AC/DC
110 A - 110 V AC
110 D - 110 V DC
240 A - 240 V AC
220 D - 220 V DC

Note: Colours available - R - Red, G - Green, Y - Yellow, W - White/Opal, B - Blue, A - Amber

eNTEGRAL ACTUATOR

- > Patented product
- > Compact and Unique Design
- > Ready to use solution for OEM & Panel Builders
- > IP 20 Terminal protection,
IP 65 & IP 67 protection with shroud
- > Current rating of 6A at 240 V AC
- > Isolated Terminals for NO+NC application
- > 500,000 Electrical operation at rated voltage
- > Mechanical life of 1 million operations
- > Can be fitted in 30 mm dia with additional accessories

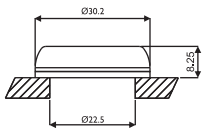

Flush Head

Cat. No. : EE□□FD1
 Contact Configuration (3rd Digit):
 1 - 1 NO
 2 - 1 NC
 3 - 1 NO + 1 NC
 4 - 2 NO
 5 - 2 NC
 Colour (4th Digit) : **R G Y W B A C**

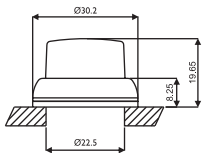

Projecting Head Push Function

Cat. No. : EE□□PD1
 Contact Configuration (3rd Digit):
 1 - 1 NO
 2 - 1 NC
 3 - 1 NO + 1 NC
 4 - 2 NO
 5 - 2 NC
 Colour (4th Digit) : **R G Y W B A C**

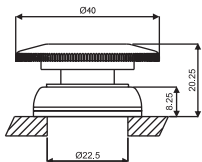

Mushroom Head Push - Turn

Cat. No. : EE□□MH1
 Contact Configuration (3rd Digit):
 1 - 1 NO
 2 - 1 NC
 3 - 1 NO + 1 NC
 4 - 2 NO
 5 - 2 NC
 Colour (4th Digit) : **R G Y C**

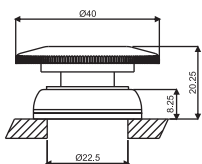

Mushroom Head Push - Function

Cat. No. : EE□□MD1
 Contact Configuration (3rd Digit):
 1 - 1 NO
 2 - 1 NC
 3 - 1 NO + 1 NC
 4 - 2 NO
 5 - 2 NC
 Colour (4th Digit) : **R G Y C**

eNTEGRAL ACTUATOR

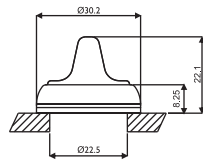

Symmetric Head Actuator

Cat. No. : **2 Position**

Non Spring Return EE□□SK1

Spring Return EE□□SI1

3 Position

Non Spring Return EE□□SL1

Spring Return EE□□SJ1

Spring Return L.H. EE□□SM1

Spring Return R.H. EE□□SN1

Contact Configuration (3rd Digit):

1 - 1 NO

2 - 1 NC

3 - 1 NO + 1 NC (Left NO)

4 - 2 NO

5 - 2 NC

6 - 1 NO + 1 NC (Right NO)

Colour (4th Digit) : **R G W C**

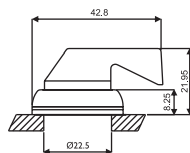

Lever Head

Cat. No. : **2 Position**

Non Spring Return EE□□LK1

Spring Return EE□□LI1

3 Position

Non Spring Return EE□□LL1

Spring Return EE□□LJ1

Spring Return L.H. EE□□LM1

Spring Return R.H. EE□□LN1

Contact Configuration (3rd Digit):

1 - 1 NO

2 - 1 NC

3 - 1 NO + 1 NC (Left NO)

4 - 2 NO

5 - 2 NC

6 - 1 NO + 1 NC (Right NO)

Colour (4th Digit) : **R G W C**

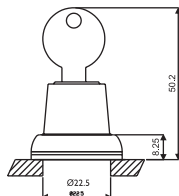

Lock & Key Rotary Type

Cat. No. : **2 Position**

Non Spring Return EE□□KK1

Spring Return EE□□KI1

3 Position

Non Spring Return EE□□KL1

Spring Return EE□□KJ1

Spring Return L.H. EE□□KM1

Spring Return R.H. EE□□KN1

Contact Configuration (3rd Digit):

1 - 1 NO

2 - 1 NC



3 - 1 NO + 1 NC (Left NO)

4 - 2 NO

5 - 2 NC

6 - 1 NO + 1 NC (Right NO)

Colour (4th Digit) : **C**

Note: In 2 position selector actuator, for operating style  replace 6th digit from K to R and for operating style  replace 6th digit from K to T.

Note: Colours available - R - Red, G - Green, Y - Yellow, W - White/Opal, B - Blue, A - Amber, C - Black

PUSH BUTTON STATIONS

- > Sleek, Compact & Unique design
- > Rounded ergonomic Enclosure
- > Good Aesthetics, occupies less space
- > Easy to grip, assemble & operate
- > Robust & maintenance free
- > Special fire retardant engineering plastic used to make it Light, corrosion resistive & non-conductive to heat
- > Comply with safety IEC standards with IP65 Ingress protection
- > Available range of Enclosures: Single, Two, Three, Four, Six & Eight Station
- > Indoor & Outdoor use
- > Available in standard configuration of Actuators & LED Indicators



Flush Head Actuator - Red with Legend - STOP, Contact - 1 'NC'
Cat. No. : EP1FAC01



Flush Head Actuator - Green with Legend - START, Contact - 1 'NO'
Cat. No. : EP1FAB02



Two Position Symmetric Head Selector Switch - Black with Legend - OFF / ON, Contact - 1 'NO'
Cat. No. : EP1FAF08



Two Position Lock & Key Rotary Switch with Legend - OFF / ON, Contact - 1 'NO'
Cat. No. : EP1FAF12



Mushroom Head Actuator 'Push Function' with Legend - STOP, Contact - 1 'NC' for Stop
Cat. No. : EP1FAC03



Mushroom Head Actuator 'Push Turn Type' with Legend - STOP, Contact - 1 'NC' for Stop
Cat. No. : EP1FAC05



Flush Head Actuator - Green with Legend - START, Contact - 1 'NO' (Station One)



Flush Head Actuator - Red with Legend - STOP, Contact - 1 'NC' (Station Two)
Cat. No. : EP2FAH0201



Flush Head Actuator - Green with Legend - START, Contact - 1 'NO' (Station One)
Mushroom Head Actuator 'Push Turn Type' with Legend - STOP, Contact - 1 'NC' (Station Two)
Cat. No. : EP2FAH0205



LED Indicator 240V AC - Red (Station One)



Flush Head Actuator - Green with Legend - START, Contact - 1 'NO' (Station Two)



Flush Head Actuator - Red with Legend - STOP, Contact - 1 'NC' (Station Three)



Cat. No. : EP3FAU1X0201

Flush Head Actuator - Green with Legend - FORWARD, Contact - 1 'NO' (Station Two)

Flush Head Actuator - Red with Legend - STOP, Contact - 1 'NC' (Station Two)

Flush Head Actuator - Green with Legend - REVERSE, Contact - 1 'NO' (Station Three)

Cat. No. : EP3FAR020102

Flush Head Actuator - Green with Legend - UP, Contact - 1 'NO' (Station Two)

Flush Head Actuator - Red with Legend - STOP, Contact - 1 'NC' (Station Two)

Flush Head Actuator - Green with Legend - DOWN, Contact - 1 'NO' (Station Three)

Cat. No. : EP3FAS020102

All 7 Flush Head Actuators with NO Contact & Mushroom Head Push Turn
Cat. No. : EP8F02

Single Station Enclosure Box without Actuator
Cat. No. : EP1FAA

Two Station Enclosure Box without Actuator
Cat. No. : EP2FAA

Three Station Enclosure Box without Actuator
Cat. No. : EP3FAA

Eight Station Enclosure Box without Actuator
Cat. No. : EP8FAA



Note: Mentioned products are available as ex-stock, for any special requirement please contact us.

GEN NEXT PUSH BUTTON ACTUATOR

- > Unique & Compact design
- > Screw less, quick & easy assembly
- > Stackable design for Contact Blocks
- > Easy identification for NO / NC Blocks
- > Self wiping contacts
- > IP20 finger-safe screw terminals
- > Special fire retardant Plastic Housings to prevent accidental contact with live circuits
- > Electrical life more than 0.5 million & Mechanical life more than 1.0 million
- > International approvals for worldwide use

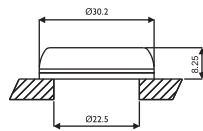

Flush Head

Cat. No. : EMN□FD1

Colour (4th Digit) : **R** **G** **C** **Y** **W** **B** **A** **F**

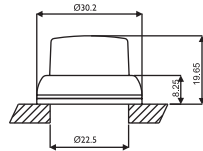

Projecting Head Push Function

Cat. No. : EMN□PD1

Colour (4th Digit) : **R** **G** **C** **Y** **W** **B** **A** **F**

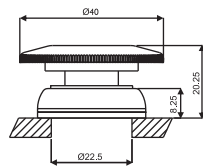

Mushroom Head Push - Turn Function

Cat. No. : EMN□MH1

Colour (4th Digit) : **R** **G** **C** **Y**

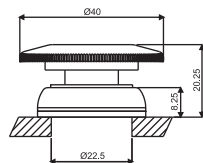

Mushroom Head Push - Function

Cat. No. : EMN□MD1

Colour (4th Digit) : **R** **G** **C** **Y**

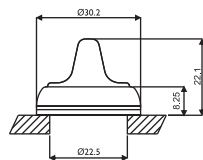

Symmetric Head

Cat. No. : **2 Position**

Non Spring Return EMN□SK1

Spring Return EMN□S11

3 Position

Non Spring Return EMN□SL1

Spring Return EMN□SJ1

Spring Return L.H. EMN□SM1

Spring Return R.H. EMN□SN1

Colour (4th Digit) : **R** **G** **C** **W**

Note: 1. Actuators & Selector Actuators with black ABS collar are offered as Standard

2. Actuators (except Mushroom Head Push - Pull Actuators) are also available with chrome plated ABS & Brass collar.

- For Brass Collar replace 7th digit 1 by 2 Eg. EMNPD **2**, For Chrome plated ABS Collar replace 7th digit 1 by 3 Eg. EMNPD **3**

3. For Non-Illuminated Actuator / Selector Actuator at least 1 NO or 1 NC Block required to make a complete Assembly.

eg. EMNRFD1 + EC1C makes complete assembly of flush head actuator with 1 NO Block.

4. Colours available: R - Red, G - Green, C - Black, Y - Yellow, W - White/Opal, B - Blue, A - Amber, F - Gray

GEN NEXT PUSH BUTTON ACTUATOR & CONTACT BLOCKS

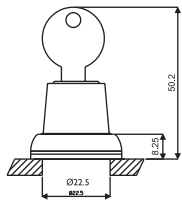

Lock & Key Rotary Type

Cat. No. : **2 Position**
 Non Spring Return EMN□KK1
 Spring Return EMN□KI1
3 Position
 Non Spring Return EMN□KL1
 Spring Return EMN□KJ1
 Spring Return L.H. EMN□KM1
 Spring Return R.H. EMN□KN1
 Colour (4th Digit) : C

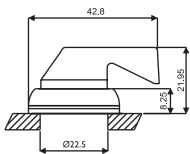

Lever Head

Cat. No. : **2 Position**
 Non Spring Return EMN□LK1
 Spring Return EMN□LI1
3 Position
 Non Spring Return EMN□LL1
 Spring Return EMN□LJ1
 Spring Return L.H. EMN□LM1
 Spring Return R.H. EMN□LN1
 Colour (4th Digit) : R C W

Note: In 2 position selector actuator, for operating style replace 4th digit from K to R and for operating style replace 4th digit from K to T.

MODULAR CONTACT BLOCKS



'NO' BLOCK

Cat. No. : EC1C



'NC' BLOCK

Cat. No. : EC2C

Note: Colours available - R - Red, G - Green, C - Black, Y - Yellow, W - White/Opal, B - Blue, A - Amber, F - Gray

GEN NEXT LED ACTUATORS

- > SMD LED technology
- > Uniform Illumination
- > Snap fit & easy assembly
- > Wide voltage range
- > Operating life more than 0.1 million Burning hrs
- > Available in six colors
- > Available with all actuators (Flush head, Projecting Head & Selector actuators)
- > Passes surge test 2 KV & HV test of 1.5KV

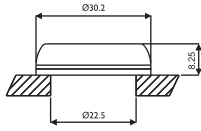

Flush Head

Cat. No. : EAL□□□□□FD
 Colour (4th Digit) : **R G Y A B W**
 Voltage (5th, 6th, 7th & 8th Digit):
 012 C - 12 V AC/DC
 024 C - 24 V AC/DC
 048 C - 48 V AC/DC
 064 C - 64 V AC/DC
 110 A - 110 V AC
 240 A - 240 V AC

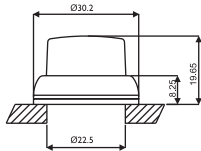

Projecting Head Push Function

Cat. No. : EAL□□□□□PD
 Colour (4th Digit) : **R G Y A B W**
 Voltage (5th, 6th, 7th & 8th Digit):
 012 C - 12 V AC/DC
 024 C - 24 V AC/DC
 048 C - 48 V AC/DC
 064 C - 64 V AC/DC
 110 A - 110 V AC
 240 A - 240 V AC

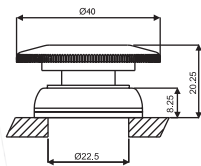

Projecting Head Push - Push Function

Cat. No. : EAL□□□□□PF
 Colour (4th Digit) : **R G Y A B W**
 Voltage (5th, 6th, 7th & 8th Digit):
 012 C - 12 V AC/DC
 024 C - 24 V AC/DC
 048 C - 48 V AC/DC
 064 C - 64 V AC/DC
 110 A - 110 V AC
 240 A - 240 V AC

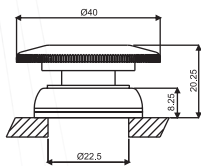

Twin Touch

Cat. No. : EAL□□□□□TD
 Colour (4th Digit) : **Y A**
 Voltage (5th, 6th, 7th & 8th Digit):
 012 C - 12 V AC/DC
 024 C - 24 V AC/DC
 048 C - 48 V AC/DC
 064 C - 64 V AC/DC
 110 A - 110 V AC
 240 A - 240 V AC

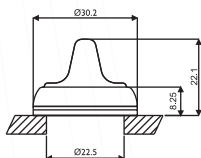

Selector Actuator with Gen Next LED

Cat. No. : **2 Position**
 Non Spring Return EAL□□□□□SK
 Spring Return EAL□□□□□SI
3 Position
 Non Spring Return EAL□□□□□SL
 Spring Return EAL□□□□□SJ
 Spring Return L.H. EAL□□□□□SM
 Spring Return R.H. EAL□□□□□SN

Colour (4th Digit) : **R G Y A B W**
 Voltage (5th, 6th, 7th & 8th Digit):
 012 C - 12 V AC/DC
 024 C - 24 V AC/DC
 048 C - 48 V AC/DC
 064 C - 64 V AC/DC
 110 A - 110 V AC
 240 A - 240 V AC

Note* : In 2 position selector actuator, for operating style replace 10th digit from K to R and for operating style replace 10th digit from K to T. LED Actuator assembly comes with LED holder. Contact Block has to be ordered Separately
 *LED Holder is available as Spare.

Note: Colours available - **R** - Red, **G** - Green, **Y** - Yellow, **W** - White/Opal, **B** - Blue, **A** - Amber

TOWER LIGHTS

CHOOSE
DIFFERENT
COLOURS
SET YOUR
OWN COMBO



E3EE
TOWERLights

- > Sleek & Stackable Design
- > SMD LED technology
- > Uniform & bright illumination
- > Continuous, Flashing and Rotary Integrated LED Light Modules available
- > Flexibility to upgrade from Single LED Unit to multiple LED Units
- > IP 65 protection | Wide voltage range from 24V AC/DC to 240V AC
- > Optional feature of Buzzer with dual sound mode - continuous & intermittent with 80 DB output.

INTERNATIONAL APPROVALS:



The  standards extend to:

1 | 2 | 3 | 3R | 4 | 4X | 12 | 13
Indoor or outdoor use primarily to provide a degree of protection against corrosion, windblown dust and rain, splashing water, hose-directed water, and damage from external ice formation.

TECHNICAL INFORMATION

Outer diameter	Ø50mm
Degree of protection	IP65 & UL (1 2 3 3R 4 4X 12 13)
LED type	SMD
Lens colour	RED / GREEN / AMBER / BLUE / WHITE
Luminous mode	Continuous, Blinking & Revolving
Buzzer colour	Black
Buzzer sound level	80dB ± 5dB
Sounding mode	Continuous & Intermittent
Voltage range	24V AC/DC, 110V AC, 240V AC
Limit of operating voltage	±10% of rated voltage
Operating temperature	-30°C to 60°C
Surge test	2 KV
HV test for 60 sec.	1.5 KV
Current rating	20-40mA for 24VAC/DC 10-20mA for 110VAC & 240VAC

Dimensions

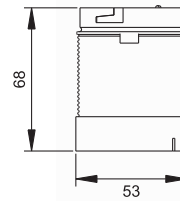
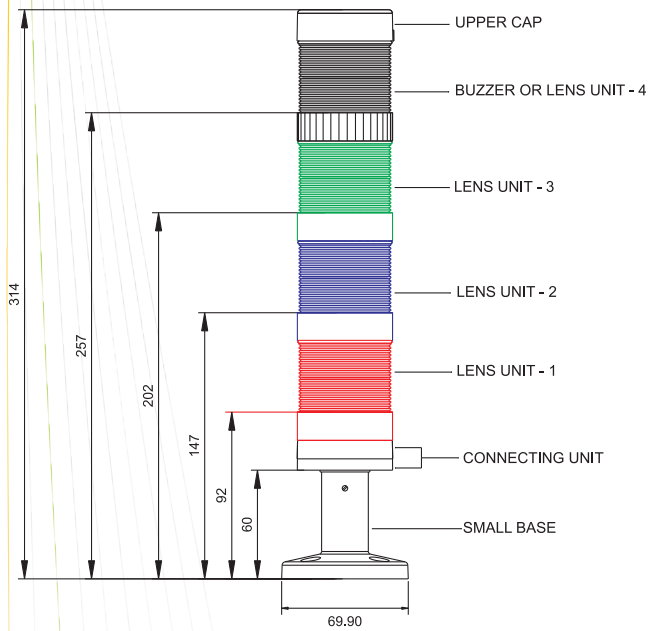

LENS UNIT FOR TOWER LIGHT

COUNTER BORE Ø11.0/Ø5.2, 4Nos.
(SCREW SIZE - M5)

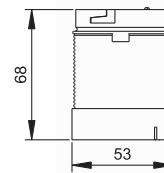
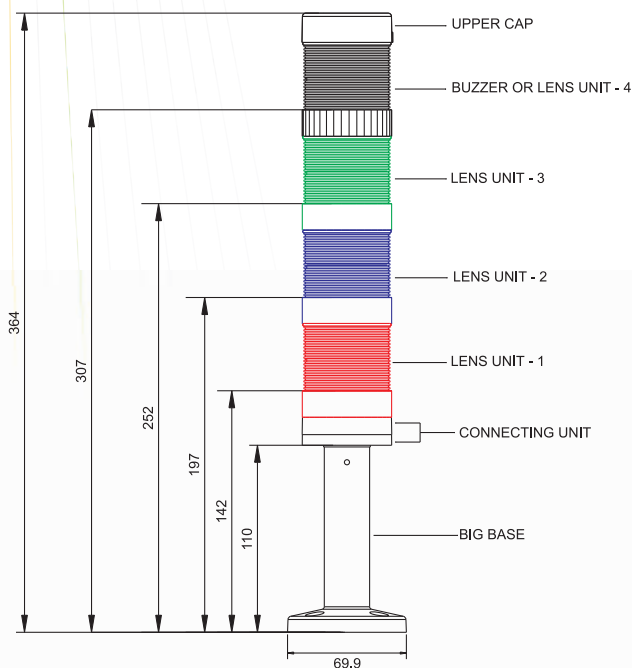
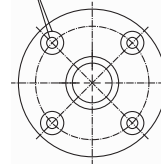

LENS UNIT FOR TOWER LIGHT

COUNTER BORE Ø11.0/Ø5.2, 4Nos.
(SCREW SIZE - M5)

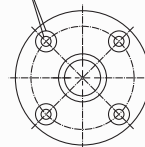

BOTTOM VIEW

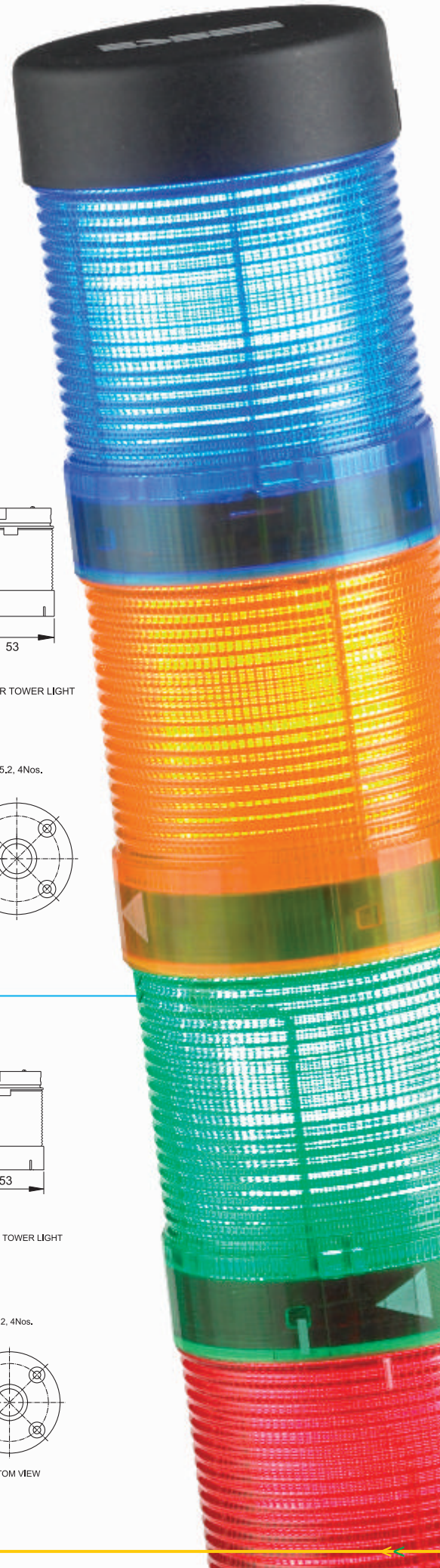

TOWER LIGHTS

Ordering Information

	DESCRIPTION	CODE
Tower Light		TW
Base	Small Base (SB)	1
	Big Base (BB)	2
Voltage	240V AC	X
	110V AC	W
	24V AC/DC	U
Unit colour	Red	R
	Green	G
	Amber	A
	Blue	B
	White	W
Luminous mode	Continuous	1
	Blinking	2
	Revolving	3
Buzzer*	Continuous	Z1
	Intermittent	Z2

TW 1 X R 1 G 1 A 2 B 1

For example :

Cat. No. TW1XR1G1A2B1

Description:
Tower Light with small base
240 VAC with Red, Green continuous,
Amber blinking & Blue continuous
illumination

* Buzzer has to be used as last unit in the stack. Maximum number of stacks possible is four.

Standard Available Combinations

Tower light without Buzzer

Type	Description	Cat No.
Single Stack	Tower Light with Small Base 240 V AC with Red continuous illumination.	TW1XR1
Single Stack	Tower Light with Small Base 240 V AC with Red Blinking illumination.	TW1XR2
Two Stack	Tower Light with Small Base 240 V AC with Red continuous & Green continuous illumination.	TW1XR1G1
Two Stack	Tower Light with Small Base 024 V AC/DC with Red Blinking & Green Blinking illumination.	TW1UR2G2
Three Stack	Tower Light with Small Base 240 V AC with Red continuous, Green continuous & Blue continuous illumination.	TW1XR1G1B1
Three Stack	Tower Light with Small Base 240 V AC with Green continuous, Blue continuous & Red Blinking illumination.	TW1XG1B1R2
Four Stack	Tower Light with Small Base 240 V AC with Red continuous, Green continuous, Blue continuous & Amber continuous illumination.	TW1XR1G1B1A1

Tower light with Buzzer

Type	Description	Cat No.
Single Stack	Tower Light with Small Base 240 V AC with Buzzer continuous	TW1XZ1
Two Stack	Tower Light with Small Base 240 V AC with Red continuous illumination & Buzzer continuous	TW1XR1Z1
Two Stack	Tower Light with Small Base 024 V AC/DC with Red Blinking illumination & Buzzer continuous	TW1UR2Z1
Three Stack	Tower Light with Small Base 240 V AC with Red continuous, Green continuous illumination & Buzzer continuous	TW1XR1G1Z1
Three Stack	Tower Light with Small Base 024 V AC/DC with Red Blinking, Green continuous illumination & Buzzer continuous	TW1UR2G1Z1
Four Stack	Tower Light with Small Base 240 V AC with Red continuous, Blue continuous illumination & Buzzer continuous	TW1XR1G1B1Z1
Four Stack	Tower Light with Small Base 024 V AC/DC with Green continuous, Blue continuous, Red Blinking illumination & Buzzer continuous	TW1UG1B1R2Z1

Note: Mentioned products are available as ex-stock, for any special requirement please refer ordering information OR contact us on following address.

TECHNICAL SPECIFICATIONS

GEN NEXT LED INDICATORS & LED ACTUATOR

Product	16 mm Gen Next LED Indicators	22.5 mm Gen Next LED Indicators	Gen Next LED Actuators
Rated Voltage	12 V AC/DC, 24 V AC/DC, 30 V AC/DC, 48 V AC/DC, 63.5 V AC/DC, 110 V AC/DC, 240 V AC	12 V AC/DC, 24 V AC/DC, 30 V AC/DC, 48 V AC/DC, 63.5 V AC/DC, 110 V AC, 110 V DC 240 V AC, 240V DC	12 V AC/DC, 24 V AC/DC, 30 V AC/DC, 48 V AC/DC, 63.5 V AC/DC, 110 V AC, 110 V DC 240 V AC, 240V DC
Operating Voltage	-20% to +10% of rated voltage	-20% to +10% of rated voltage	-20% to +10% of rated voltage
Type of LED	SMD LEDs	SMD LEDs	SIDE VIEW SMD LEDs
Available Colours	RED/GREEN/YELLOW/ AMBER/BLUE/WHITE	RED/GREEN/YELLOW/ AMBER/BLUE/WHITE	RED/GREEN/YELLOW/ AMBER/BLUE/WHITE
Life	1 lac burning hour	1 lac burning hour	1 lac burning hour
Operating Temperature	-30°C to 60°C	-30°C to 60°C	-30°C to 60°C
Storage Temperature	-25°C to 70°C	-25°C to 70°C	-25°C to 70°C
Surge Test	2KV	2KV	2KV
Hv test for 60 sec.	1.5KV	1.5KV	1.5KV
Degree of Protection	Above panel : IP65 For terminals : IP20	Above panel : IP65 For terminals : IP20	Above panel : IP65 For terminals : IP20
International Approvals	CE	CE, UL	CE

GEN NEXT INTEGRAL ACTUATOR

Product	Gen Next Integral Actuator
Function Type	Push, Push-Push, Push Turn, Selector
Contact	NO, NC, NO + NC, 2NO, 2NC
Type	Non-Illuminated
Colour	RED / GREEN / BLACK / YELLOW / WHITE / BLUE / ORANGE
Rated Operational Voltage	230 V AC
Rated Operational Voltage	6 AMP
Electrical Cycle	5 Lac Operations
Mechanical Cycle	10 Lac Operations
Operating Temperature	-30°C to 60°C
Storage Temperature	-25°C to 70°C
Operating Force	Max. 8 N
HV Test for 60sec.	2.5KV (All Terminals Shorted Together)
Degree of protection	IP20 for Terminals & IP65 above panel
Rated insulation Voltage	600 V AC
Terminals	Suitable for flexible or solid conductors from 2 x 1 mm ² to 2 x 2.5 mm ²
Current Carrying Material	
Contact Type Material	Make & Break AgNi/AgCdo
Insulation Resistance at 500 V DC	>50M Ω
Contact Resistance	< 20m Ω
MV drop at 16 A DC	< 200 mV
Disposition of Contacts: <input type="checkbox"/> Contact Open <input checked="" type="checkbox"/> Contact Close	<p>0 1 2 3 3.7 Stroke (mm)</p>

TOWER LIGHTS

GEN NEXT MODULAR CONTACT BLOCK

Product	Gen Next Integral Actuator
Electrical Cycle	5 Lac Operations
Mechanical Cycle	10 Lac Operations
Operating Temperature	-30°C to 60°C
Storage Temperature	-30°C to 65°C
Operating Force	Max. 3.5 N
HV Test for 60sec.	2.5KV
Rated insulation Voltage	600 V AC
Terminals	Suitable for flexible or solid conductors from 2 x 1 mm ²
Current Carrying Material Contact Type Contact Material	Make & Break AgNi
Rated Thermal Current	16Amp with, 2.5mm ² flexible conductors
Insulation Resistance at 500 V DC	>50M Ω
Contact Resistance	< 20m Ω
MV drop at 16 A DC	< 100 mV
Disposition of Contacts: <input type="checkbox"/> Contact Open <input checked="" type="checkbox"/> Contact Close	<p>Stroke (mm)</p> <p>0 1 2 3 3.8</p>

TECHNICAL SPECIFICATION OF PUSH BUTTON STATION / ENCLOSURE

1. **Degree of Protection** : IP 65 for Push Button Enclosure with Indicators & Actuators

2. **Safety** : Fully insulated to house electrical & electronic equipment w.r.t. protection against electric shock.

3. **Material** :

Bottom Cover : Tough, Impact resistant & fire retardant ABS.

Top Cover : Tough, Impact resistant & fire retardant ABS.

Gasket : Nitrile rubber, which is good resistant to Oil & acids.

Screws : Half threaded Self tapping Cold Forged Screws with blacodising.

4. **Dimensions**:

Type of Enclosure	Single	Two	Three	Eight
Size in mm (Length, Width, Depth)	65x55x33	100x55x53	134x55x53	305x55x53

Screw Size for wall Mounting : M3.5 mm Insertion of Screws directly through base cover.

Maintenance: Do not need any particular maintenance. If necessary, soap, and water can be used for cleaning. If detergent is used, enclosure should be rinsed well clean water. Do not use any solvents to clean the enclosures.

Chemical resistance : ABS Products are almost completely resistant to aqueous acids, alkalis and salts, Concentrated phosphoric and hydrochloric acids have little effect. Low KB solvents, alcohols and animal / vegetable / mineral oils produce insignificant changes. Aromatic or chlorinated hydrocarbons and high KB solvents cause marked swelling. Esters ketones and unsaturated alkalis are solvents for ABS and should not be used.

Temperature Range: Long term exposure to temperatures above 70°C should be avoided. No significant change in impact strength is noticed up to -20°C.

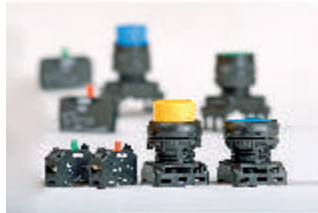
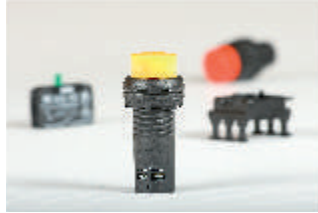

Esbee Industrial Combines

J - 159, M.I.D.C., Bhosari, Pune 411026.
Maharashtra, INDIA.
Tel. +91 20 30681002 / 6 Fax +91 20 30681007.
info@esbeeswitches.com
www.esbeeswitches.com